

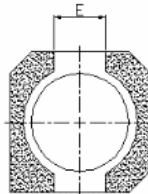

Chilisin Electronics Singapore Pte Ltd

SMD Shielded Power Chokes, CRH Series

CONFIGURATION & DIMENSIONS

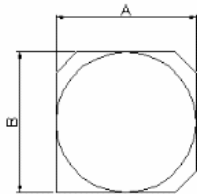

TYPE	A	B	C	E
CRH0402 Series	4.8±0.5	4.8±0.5	2.0 max.	1.6 ref.
CRH0403 Series	4.8±0.5	4.8±0.5	3.0 max.	1.6 ref.
CRH0502 Series	5.6±0.5	5.6±0.5	2.0 max.	1.8 ref.
CRH0503 Series	5.6±0.5	5.6±0.5	3.0 max.	1.8 ref.
CRH0603 Series	6.6±0.5	6.6±0.5	3.0 max.	2.2 ref.
CRH0604 Series	6.6±0.5	6.6±0.5	4.0 max.	2.2 ref.

MATERIALS

- (1) Core : Ferrite Core.
- (2) Wire : Enamelled copper wire.
- (3) Terminal : Ag + Cu + Ni + Sn/Pb.

GENERAL SPECIFICATION

- (1) Temp. Rise : 40°C Max
- (2) Rated Current : Base on Temp. rise & $\Delta L/L$ (0A) = 10% max.
- (3) Storage Temp. : -25°C to +85°C
- (4) Resistance To Solder Heat : 260°C, 10Sec.

[Next](#)

[Back](#)



Chilisin Electronics Singapore Pte Ltd

SMD Shielded Power Chokes, CRH Series

Electrical Characteristics

Part No.	Inductance (uH)	DCR (ohm) Max.						Rated D.C. Current (A) Max.					
		CRH0402	CRH0403	CRH0502	CRH0503	CRH0603	CRH0604	CRH0402	CRH0403	CRH0503	CRH0504	CRH0603	CRH0604
1R2	1.2		23.6m						2.56				
1R8	1.8		27.5m						2.20				
2R2	2.2		31.3m						2.04				
2R6	2.6				18m						2.60		
2R7	2.7		43.3m						1.60				
3R0	3.0				24m	24m					2.40	3.00	
3R3	3.3		49.2m				20m		1.57				3.50
3R9	3.9		64.8m				27m		1.44			2.60	
4R1	4.1			57m						1.95			
4R2	4.2				31m						2.20		
4R7	4.7		72.0m						1.32				
5R0	5.0					31m	24m					2.40	2.90
5R3	5.3				38m						1.90		
5R4	5.4			76m						1.60			
5R6	5.6		100.9m						1.17				
6R0	6.0					35m						2.25	
6R2	6.2			96m	45m		27m			1.40	1.80		2.50
6R8	6.8		108.9m						1.12				
7R3	7.3					54m						2.10	
7R4	7.4						31m						2.30
8R2	8.2		117.5m		53m				1.04		1.60		
8R6	8.6					58m						1.85	
8R7	8.7						34m						2.20
8R9	8.9			116m						1.25			
100	10	0.200	128.3m	0.124	65m	65m	38m	0.61	1.00	1.20	1.30	1.70	2.00
120	12	0.210	131.6m	0.153	76m	70m	53m	0.56	0.84	1.10	1.20	1.55	1.70
150	15	0.240	149.0m	0.196	0.103	84m	57m	0.50	0.76	0.97	1.10	1.40	1.60
180	18	0.338	166.0m	0.210	0.110	95m	92m	0.48	0.72	0.85	1.00	1.32	1.50
220	22	0.397	235.0m	0.290	0.122	0.128	96m	0.41	0.70	0.80	0.90	1.20	1.30
270	27	0.441	261.0m	0.330	0.175	0.142	0.109	0.35	0.58	0.75	0.85	1.05	1.20
330	33	0.690	378.0m	0.386	0.189	0.165	0.124	0.32	0.56	0.65	0.75	0.97	1.10
390	39	0.709	383.7m	0.520	0.212	0.210	0.138	0.30	0.50	0.57	0.70	0.86	1.00
470	47	0.922	587.0m	0.595	0.260	0.238	0.155	0.28	0.48	0.54	0.62	0.80	0.95
560	56	1.08	624.5m	0.665	0.305	0.277	0.202	0.26	0.41	0.50	0.58	0.73	0.85
680	68	1.30	699.0m	0.840	0.355	0.304	0.234	0.24	0.35	0.43	0.52	0.65	0.75
820	82	1.56	914.8m	0.978	0.463	0.390	0.324	0.22	0.32	0.41	0.46	0.60	0.70
101	100	1.73	1.02	1.20	0.520	0.535	0.358	0.20	0.29	0.36	0.42	0.54	0.65
121	120	2.39	1.27					0.18	0.27				
151	150	1.35	1.35					0.15	0.24				
181	180	1.54	1.54					0.14	0.22				

[Next](#)

[Back](#)